



Product manual ie20xx series - Z0220
Handleiding ie20xx series - Z0220



INDEX ELEKTRO BV
Harregatplein 15
3214 VP Zuidland
Netherlands



T. +31(0)181 452120
<http://www.indexelektro.nl>
email Sales@indexelektro.nl

IE20xx series-Rev.10.12.24



Purpose of these instructions

- Working in hazardous areas, the safety of personnel and plant depends on complying with all relevant safety regulations.
- Assembly and maintenance staff working on installations therefore have a particular responsibility. They require precise knowledge of the applicable standards and regulations.
- These instructions give a brief summary of the most important safety measures. It supplements the corresponding regulations which the staff must study.



SAFETY INSTRUCTIONS

- Use the explosion-proof control units only for its intended purpose.
- Explosion-proof control units are not suitable for Zone 0 hazardous areas!
- Incorrect or impermissible use or non-compliance with these instructions invalidates our warranty provision.
- No changes to the device impairing its explosion protection are permitted.
- Use the control units only if they are clean and undamaged, any damage can invalidate the Ex-protection.
- Observe the following during installation and operation:
 - National safety regulations;
 - National accident prevention regulations;
 - National installation regulations (e.g. IEC 60079-14);
 - Generally recognized technical regulations;
 - Safety guidelines in these operating instructions;
 - Characteristic values given on the control units.

Conformity to standards

The explosion-proof components are designed and manufactured according to standard of ISO 9001.
The explosion-proof components are conformity to the directive 94/9/EC, ATEX and the following standards:

EN IEC60079-0 : 2018
EN 60079-7 : 2015+A1:2018
EN 60079-31 : 2014

Applicable scope

Z0201 Series control units can be used in the industrie circuit of which rated working voltage is 400 VAC or below to control electrical installations

The series product can be used in zone 1, 2, 21 and zone 22.

Technical date

Ex mark  II 2 GD Ex db eb IIC Gb Ex tb IIIC Db
Test certificate CSACa 22ATEX10006U
Degree of protection IP66, IP67
Ambient temperature -40°C/-55°C ..+75°C

Certificate CSACa 22ATEX10006U



Explosion-proof Polyester wartels en verlopen

Model and implication

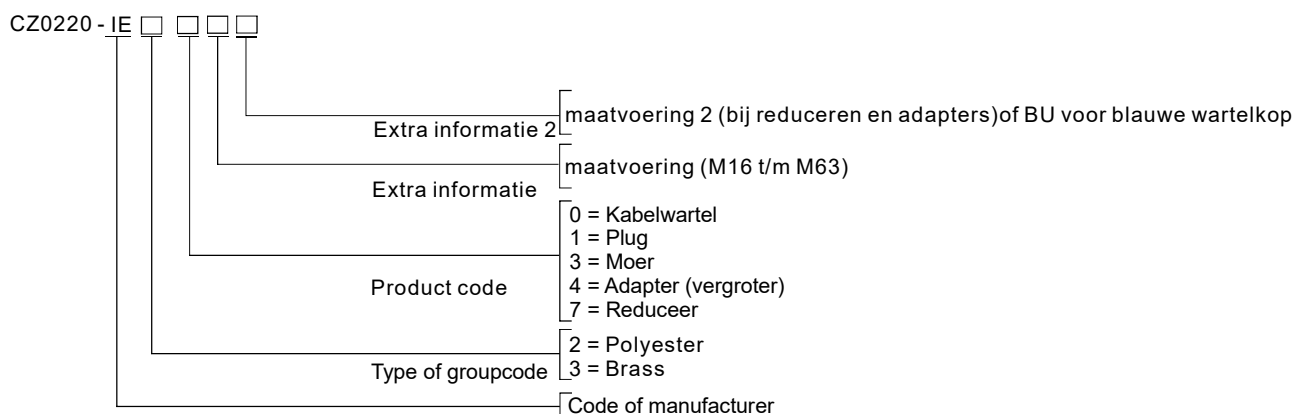



Repairs / Maintenance

- Observe the relevant national regulations for your country!
- Only parts from our company that can be used to replace or maintain, and the operation should be carried out by professional electrician!
- The following points must be checked during maintenance:
 - * Compliance with permitted temperatures;
 - * Check if there is any crack in the components.
 - * Check if the component has been fixed reliably.
 - * Check if the wiring is not loose or fixed.
 - * Check if the flame-proof joints is damaged.

Recycling / Disposal

- The respective valid national regulations for waste disposal shall be observed when disposing of apparatus!
- We are pleased to answer any questions. In this case you can contact INDEX ELEKTRO BV.

Polyamide kabelwartels type IE2xxx

Afbeelding Illustration	D	C		K (mm)	LH (mm)	Standard thread		Long thread	
		Min.	Max.			L (mm)	Type nr	L (mm)	Type nr
 Ex e	M16x1.5	5.5	9	20	27	10	IE2016	16	IE2016L
	M20x1.5	6	13	24	31	11	IE2020	16	IE2020L
	M25x1.5	9	17	29	36	11	IE2025	16	IE2025L
	M32x1.5	13	21	36	43	12	IE2032	16	IE2032L
	M40x1.5	17	28	46	47	14	IE2040	-	-
	M50x1.5	22	35	55	54	16	IE2050	-	-
	M63x1.5	27	48	68	57	16	IE2063	-	-
	M25x1.5	4x3	4x6	29	36	11	IE2024	16	IE2024L
	M32x1.5	4x5	4x7	36	43	12	IE2034	16	IE2034L
 Ex i	M16x1.5	5.5	9	20	27	10	IE2016 BU	16	IE2016 BUL
	M20x1.5	6	13	24	31	11	IE2020 BU	16	IE2020 BUL
	M25x1.5	9	17	29	36	11	IE2025 BU	16	IE2025 BUL
	M32x1.5	13	21	36	43	12	IE2032 BU	16	IE2032 BUL
	M40x1.5	17	28	46	47	14	IE2040 BU	-	IE2040 BUL
	M50x1.5	22	35	55	54	16	IE2050 BU	-	IE2050 BUL
	M63x1.5	27	48	68	57	16	IE2063 BU	-	IE2063 BUL
	M25x1.5	4x3	4x6	29	36	11	IE2024 BU	16	IE2024 BUL
	M32x1.5	4x5	4x7	36	43	12	IE2034 BU	16	IE2034 BUL

Afmetingen Dimensions

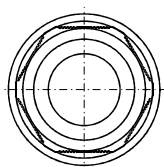

Enkelvoudig
Single-hole type

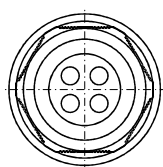

Meervoudig
Multi-hole type

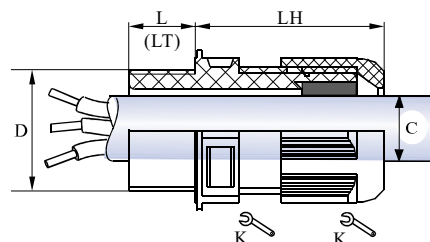

Polyamide reduceerring Ex e
Polyamide reducer Ex e

Afbeelding Illustration	Tapmaat Male thread	Tapmaat inwendig Female thread	Taplengte Length thread	Type
	M16x1.5	M12x1.5	8mm	IE271612
	M20x1.5	M12x1.5	8mm	IE272012
	M20x1.5	M16x1.5	8mm	IE272016
	M25x1.5	M12x1.5	8mm	IE272512
	M25x1.5	M16x1.5	8mm	IE272516
	M25x1.5	M20x1.5	8mm	IE272520
	M32x1.5	M16x1.5	10mm	IE273216
	M32x1.5	M20x1.5	10mm	IE273220
	M32x1.5	M25x1.5	10mm	IE273225
	M40x1.5	M20x1.5	10mm	IE274020
	M40x1.5	M25x1.5	10mm	IE274025
	M40x1.5	M32x1.5	10mm	IE274032
	M50x1.5	M32x1.5	12mm	IE275032
	M50x1.5	M40x1.5	12mm	IE275040
	M63x1.5	M40x1.5	12mm	IE276340
M63x1.5	M50x1.5	12mm	IE276350	

Polyamide adapter Ex e
Polyamide adapter Ex e

Afbeelding Illustration	Tapmaat F Male F	Tapmaat C Female C	Inwendig E intern E ϕ	Uitwendig D Outside D ϕ	Type
	M16x1.5	M20x1.5	10,0 mm	27,5mm	IE241620
	M20x1.5	M25x1.5	12,5 mm	35,5 mm	IE242025
	M25x1.5	M32x1.5	17,5 mm	41 mm	IE242532
	M32x1.5	M40x1.5	23,5 mm	50 mm	IE243240
	M40x1.5	M50x1.5	33,0 mm	60 mm	IE244050
	M50x1.5	M63x1.5	42,5 mm	80 mm	IE245063

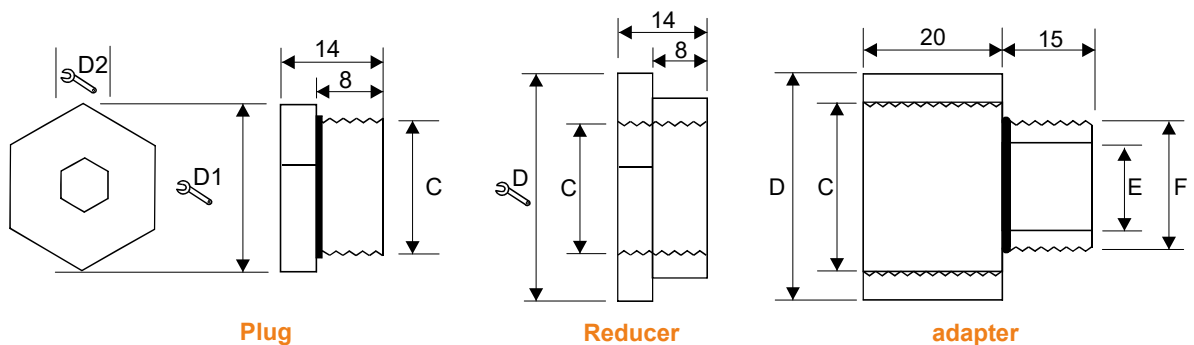

Polyamide blindplug Ex e Polyamide plug Ex e

Afbeelding Illustration	Tapmaat Male thread	Taplengte Length thread	Type
	M16x1.5	11 mm	IE2116
	M20x1.5	12 mm	IE2120
	M25x1.5	12 mm	IE2125
	M32x1.5	14 mm	IE2132
	M40x1.5	14 mm	IE2140
	M50x1.5	15 mm	IE2150
	M63x1.5	15 mm	IE2163

Polyamide reduceerring Ex e

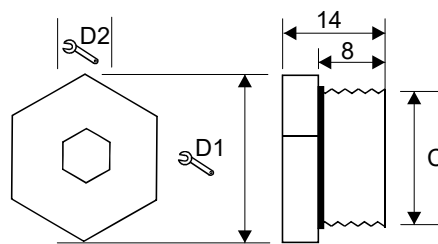

Plug

Afdichtplug voor wartel Ex e Blanking plug for gland Ex e

Afbeelding Illustration	voor kabelwartel for cable gland	D (mm)	C (mm)	LT (mm)	L (mm)	Type
	IE2012 / IE2016 / IE2020 / IE3012	Ø6	Ø5	12	8	IE3816
	IE2025 / IE3016	Ø12	Ø8	20	15	IE3820
	IE3020	Ø16	Ø11.5	25	18	IE3825
	IE2032 / IE3025	Ø20	Ø16.5	28	20	IE3832

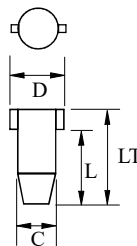

IE3816

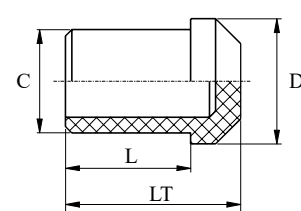

IE3820 / IE3825 / IE3832

Afmetingen
Dimensions

Polyamide Moer Polyamide Locknut

Afbeelding Illustration	Maat Size	Type
	M16	IE2316
	M20	IE2320
	M25	IE2325
	M32	IE2332
	M40	IE2340
	M50	IE2350
	M63	IE2363

Wartelsleutel Gland spanner

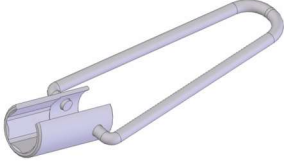
Afbeelding Illustration	Maat Size	Type
 <p>De 4024 wartelsleutel is bedoeld voor montage van polyamide kabelwartels. The 4024 gland spanner is to be used for mounting of polyamide cable glands.</p>	M16	IE2916
	M20	IE2920
	M25	IE2925
	M32	IE2932
	M40	IE2940